

A.P. NO. 011-471-04; 011-472-03; 011-472-10; 011-472-20; 011-472-22; 011-473-05;  
011-473-07; 011-473-18; 011-473-21; 011-474-06; 011-473-09; 011-474-19;  
011-475-02; 011-475-03; 011-475-05; 011-475-07; 011-475-12; 011-475-13;  
011-476-05; 011-476-06; 011-476-07; 011-476-09

Escrow No. 2002-63074-MH  
R.P.T.T. \$4,379.25

WHEN RECORDED MAIL TO:  
280 Island Avenue LLC  
2305 Stowe  
Reno, NV 89511

MAIL TAX STATEMENT TO:  
Same as above

---

**GRANT, BARGAIN and SALE DEED**

FOR A VALUABLE CONSIDERATION, receipt of which is hereby acknowledged,

**KEVIN L. JOHNSON and REBECCA G. JOHNSON, husband and wife as joint tenants as to an undivided 10% interest, and GRADY W. KROMER and CHERYL L. KROMER, Trustees of THE KROMER FAMILY TRUST dated February 25, 1987 as to an undivided 90% interest, as tenants in common.**

do(es) hereby *GRANT, BARGAIN and SELL* to

**280 ISLAND AVENUE, LLC, a Nevada limited liability company**

the real property situate in the County of Washoe, State of Nevada, described as follows:

SEE EXHIBIT 'A' ATTACHED FOR LEGAL DESCRIPTION

**RESERVING UNTO THE GRANTOR ALL WATER AND WATER RIGHTS, BOTH SURFACE RIGHTS AND GROUND WATER RIGHTS, DITCH RIGHTS, CONVEYANCE RIGHTS, DITCH STOCK OR APPURTENANCES OF ANY KIND OR NATURE RELATING TO WATER AND WATER RIGHTS APPURTENANT TO OR USED IN CONNECTION WITH THE REAL PROPERTY DESCRIBED HEREIN.**





Escrow No. 2001-58354-MH

**TOGETHER** with all other tenanments, herditaments and appurtenaces, including easements, if any, thereto belonging or appertaining, and any reversions, remainders, rents, issues or profits thereof, except as reserved above.

Dated: 3/28/02

\_\_\_\_\_  
KEVIN L. JOHNSON  
  
\_\_\_\_\_  
REBECCA G. JOHNSON

THE KROMER FAMILY TRUST dated  
February 25, 1987

BY:   
\_\_\_\_\_  
Grady W. Kromer, Trustee

BY:   
\_\_\_\_\_  
Cheryl L. Kromer, Trustee

STATE OF NEVADA  
COUNTY OF WASHOE

This instrument was acknowledged before me on March 28, 2002, by  
KEVIN L. JOHNSON AND REBECCA G. JOHNSON.

\_\_\_\_\_  
Notary Public

M. MOLNAR  
Notary Public - State of Nevada  
Appointment Recorded in Washoe County  
No: 97-1967-2 - Expires June 21, 2005

STATE OF NEVADA  
COUNTY OF WASHOE

This instrument was acknowledged before me on March 28, 2002, by  
GRADY W. KROMER AND CHERYL L. KROMER, Trustees of The Kromer Family Trust.

\_\_\_\_\_  
Notary Public

M. MOLNAR  
Notary Public - State of Nevada  
Appointment Recorded in Washoe County  
No: 97-1967-2 - Expires June 21, 2005

## DESCRIPTION

All that certain lot, piece or parcel of land situate in the County of Washoe, State of Nevada, described as follows:

PARCEL 1:

Unit 201 of Park Towers, a condominium subdivision, Map No. 3941 filed in the office of the County Recorder of Washoe County, State of Nevada on April 13, 2001 as File No. 2542882 of Official Records.

PARCEL 2:

An undivided 1.259611% interest in the "Common Elements" as shown on the map of Park Towers, a condominium subdivision, Map No. 3941 filed in the office of the County Recorder of Washoe County, State of Nevada on April 13, 2001 as File No. 2542882 of Official Records.

PARCEL 3:

Unit 303 of Park Towers, a condominium subdivision, Map No. 3941 filed in the office of the County Recorder of Washoe County, State of Nevada on April 13, 2001 as File No. 2542882 of Official Records.

PARCEL 4:

An undivided 1.733277% interest in the "Common Elements" as shown on the map of Park Towers, a condominium subdivision, Map No. 3941 filed in the office of the County Recorder of Washoe County, State of Nevada on April 13, 2001 as File No. 2542882 of Official Records.

PARCEL 5:

Unit 402 of Park Towers, a condominium subdivision, Map No. 3941 filed in the office of the County Recorder of Washoe County, State of Nevada on April 13, 2001 as File No. 2542882 of Official Records.

PARCEL 6:

An undivided 0.985383% interest in the "Common Elements" as shown on the map of Park Towers, a condominium subdivision, Map No. 3941 filed in the office of the County Recorder of Washoe County, State of Nevada on April 13, 2001 as File No. 2542882 of Official Records.

PARCEL 7:

Unit 504 of Park Towers, a condominium subdivision, Map No. 3941 filed in the office of the County Recorder of Washoe County, State of Nevada on April 13, 2001 as File No. 2542882 of Official Records.



## Description Continued

PARCEL 8:

An undivided 1.140210% interest in the "Common Elements" as shown on the map of Park Towers, a condominium subdivision, Map No. 3941 filed in the office of the County Recorder of Washoe County, State of Nevada on April 13, 2001 as File No. 2542882 of Official Records.

PARCEL 9:

Unit 506 of Park Towers, a condominium subdivision, Map No. 3941 filed in the office of the County Recorder of Washoe County, State of Nevada on April 13, 2001 as File No. 2542882 of Official Records.

PARCEL 10:

An undivided 1.050988% interest in the "Common Elements" as shown on the map of Park Towers, a condominium subdivision, Map No. 3941 filed in the office of the County Recorder of Washoe County, State of Nevada on April 13, 2001 as File No. 2542882 of Official Records.

PARCEL 11:

Unit 605 of Park Towers, a condominium subdivision, Map No. 3941 filed in the office of the County Recorder of Washoe County, State of Nevada on April 13, 2001 as File No. 2542882 of Official Records.

PARCEL 12:

An undivided 1.266172% interest in the "Common Elements" as shown on the map of Park Towers, a condominium subdivision, Map No. 3941 filed in the office of the County Recorder of Washoe County, State of Nevada on April 13, 2001 as File No. 2542882 of Official Records.

PARCEL 13:

Unit 607 of Park Towers, a condominium subdivision, Map No. 3941 filed in the office of the County Recorder of Washoe County, State of Nevada on April 13, 2001 as File No. 2542882 of Official Records.

PARCEL 14:

An undivided 0.461857% interest in the "Common Elements" as shown on the map of Park Towers, a condominium subdivision, Map No. 3941 filed in the office of the County Recorder of Washoe County, State of Nevada on April 13, 2001 as File No. 2542882 of Official Records.



## Description Continued

PARCEL 15:

Unit 701 of Park Towers, a condominium subdivision, Map No. 3941 filed in the office of the County Recorder of Washoe County, State of Nevada on April 13, 2001 as File No. 2542882 of Official Records.

PARCEL 16:

An undivided 0.561577% interest in the "Common Elements" as shown on the map of Park Towers, a condominium subdivision, Map No. 3941 filed in the office of the County Recorder of Washoe County, State of Nevada on April 13, 2001 as File No. 2542882 of Official Records.

PARCEL 17:

Unit 802 of Park Towers, a condominium subdivision, Map No. 3941 filed in the office of the County Recorder of Washoe County, State of Nevada on April 13, 2001 as File No. 2542882 of Official Records.

PARCEL 18:

An undivided 0.985383% interest in the "Common Elements" as shown on the map of Park Towers, a condominium subdivision, Map No. 3941 filed in the office of the County Recorder of Washoe County, State of Nevada on April 13, 2001 as File No. 2542882 of Official Records.

PARCEL 19:

Unit 805 of Park Towers, a condominium subdivision, Map No. 3941 filed in the office of the County Recorder of Washoe County, State of Nevada on April 13, 2001 as File No. 2542882 of Official Records.

PARCEL 20:

An undivided 1.266172% interest in the "Common Elements" as shown on the map of Park Towers, a condominium subdivision, Map No. 3941 filed in the office of the County Recorder of Washoe County, State of Nevada on April 13, 2001 as File No. 2542882 of Official Records.

PARCEL 21:

Unit 906 of Park Towers, a condominium subdivision, Map No. 3941 filed in the office of the County Recorder of Washoe County, State of Nevada on April 13, 2001 as File No. 2542882 of Official Records.



## Description Continued

PARCEL 22:

An undivided 1.050988% interest in the "Common Elements" as shown on the map of Park Towers, a condominium subdivision, Map No. 3941 filed in the office of the County Recorder of Washoe County, State of Nevada on April 13, 2001 as File No. 2542882 of Official Records.

PARCEL 23:

Unit 1103 of Park Towers, a condominium subdivision, Map No. 3941 filed in the office of the County Recorder of Washoe County, State of Nevada on April 13, 2001 as File No. 2542882 of Official Records.

PARCEL 24:

An undivided 1.733277% interest in the "Common Elements" as shown on the map of Park Towers, a condominium subdivision, Map No. 3941 filed in the office of the County Recorder of Washoe County, State of Nevada on April 13, 2001 as File No. 2542882 of Official Records.

PARCEL 25:

Unit 1202 of Park Towers, a condominium subdivision, Map No. 3941 filed in the office of the County Recorder of Washoe County, State of Nevada on April 13, 2001 as File No. 2542882 of Official Records.

PARCEL 26:

An undivided 0.985383% interest in the "Common Elements" as shown on the map of Park Towers, a condominium subdivision, Map No. 3941 filed in the office of the County Recorder of Washoe County, State of Nevada on April 13, 2001 as File No. 2542882 of Official Records.

PARCEL 27:

Unit 1203 of Park Towers, a condominium subdivision, Map No. 3941 filed in the office of the County Recorder of Washoe County, State of Nevada on April 13, 2001 as File No. 2542882 of Official Records.

PARCEL 28:

An undivided 1.733277% interest in the "Common Elements" as shown on the map of Park Towers, a condominium subdivision, Map No. 3941 filed in the office of the County Recorder of Washoe County, State of Nevada on April 13, 2001 as File No. 2542882 of Official Records.



Description Continued

PARCEL 29:

Unit 1205 of Park Towers, a condominium subdivision, Map No. 3941 filed in the office of the County Recorder of Washoe County, State of Nevada on April 13, 2001 as File No. 2542882 of Official Records.

PARCEL 30:

An undivided 1.266172% interest in the "Common Elements" as shown on the map of Park Towers, a condominium subdivision, Map No. 3941 filed in the office of the County Recorder of Washoe County, State of Nevada on April 13, 2001 as File No. 2542882 of Official Records.

PARCEL 31:

Unit 1207 of Park Towers, a condominium subdivision, Map No. 3941 filed in the office of the County Recorder of Washoe County, State of Nevada on April 13, 2001 as File No. 2542882 of Official Records.

PARCEL 32:

An undivided 0.461857% interest in the "Common Elements" as shown on the map of Park Towers, a condominium subdivision, Map No. 3941 filed in the office of the County Recorder of Washoe County, State of Nevada on April 13, 2001 as File No. 2542882 of Official Records.

PARCEL 33:

Unit 1404 of Park Towers, a condominium subdivision, Map No. 3941 filed in the office of the County Recorder of Washoe County, State of Nevada on April 13, 2001 as File No. 2542882 of Official Records.

PARCEL 34:

An undivided 1.140210% interest in the "Common Elements" as shown on the map of Park Towers, a condominium subdivision, Map No. 3941 filed in the office of the County Recorder of Washoe County, State of Nevada on April 13, 2001 as File No. 2542882 of Official Records.

PARCEL 35:

Unit 1405 of Park Towers, a condominium subdivision, Map No. 3941 filed in the office of the County Recorder of Washoe County, State of Nevada on April 13, 2001 as File No. 2542882 of Official Records.

## Description Continued

PARCEL 36:

An undivided 1.266172% interest in the "Common Elements" as shown on the map of Park Towers, a condominium subdivision, Map No. 3941 filed in the office of the County Recorder of Washoe County, State of Nevada on April 13, 2001 as File No. 2542882 of Official Records.

PARCEL 37:

Unit 1701 of Park Towers, a condominium subdivision, Map No. 3941 filed in the office of the County Recorder of Washoe County, State of Nevada on April 13, 2001 as File No. 2542882 of Official Records.

PARCEL 38:

An undivided 2.498229% interest in the "Common Elements" as shown on the map of Park Towers, a condominium subdivision, Map No. 3941 filed in the office of the County Recorder of Washoe County, State of Nevada on April 13, 2001 as File No. 2542882 of Official Records.

PARCEL 39:

Unit 1702 of Park Towers, a condominium subdivision, Map No. 3941 filed in the office of the County Recorder of Washoe County, State of Nevada on April 13, 2001 as File No. 2542882 of Official Records.

PARCEL 40:

An undivided 2.548088% interest in the "Common Elements" as shown on the map of Park Towers, a condominium subdivision, Map No. 3941 filed in the office of the County Recorder of Washoe County, State of Nevada on April 13, 2001 as File No. 2542882 of Official Records.

PARCEL 41:

Unit 1703 of Park Towers, a condominium subdivision, Map No. 3941 filed in the office of the County Recorder of Washoe County, State of Nevada on April 13, 2001 as File No. 2542882 of Official Records.

PARCEL 42:

An undivided 0.503844% interest in the "Common Elements" as shown on the map of Park Towers, a condominium subdivision, Map No. 3941 filed in the office of the County Recorder of Washoe County, State of Nevada on April 13, 2001 as File No. 2542882 of Official Records.





Description Continued

PARCEL 43:

Unit 1801 of Park Towers, a condominium subdivision, Map No. 3941 filed in the office of the County Recorder of Washoe County, State of Nevada on April 13, 2001 as File No. 2542882 of Official Records.

PARCEL 44:

An undivided 1.266172% interest in the "Common Elements" as shown on the map of Park Towers, a condominium subdivision, Map No. 3941 filed in the office of the County Recorder of Washoe County, State of Nevada on April 13, 2001 as File No. 2542882 of Official Records.

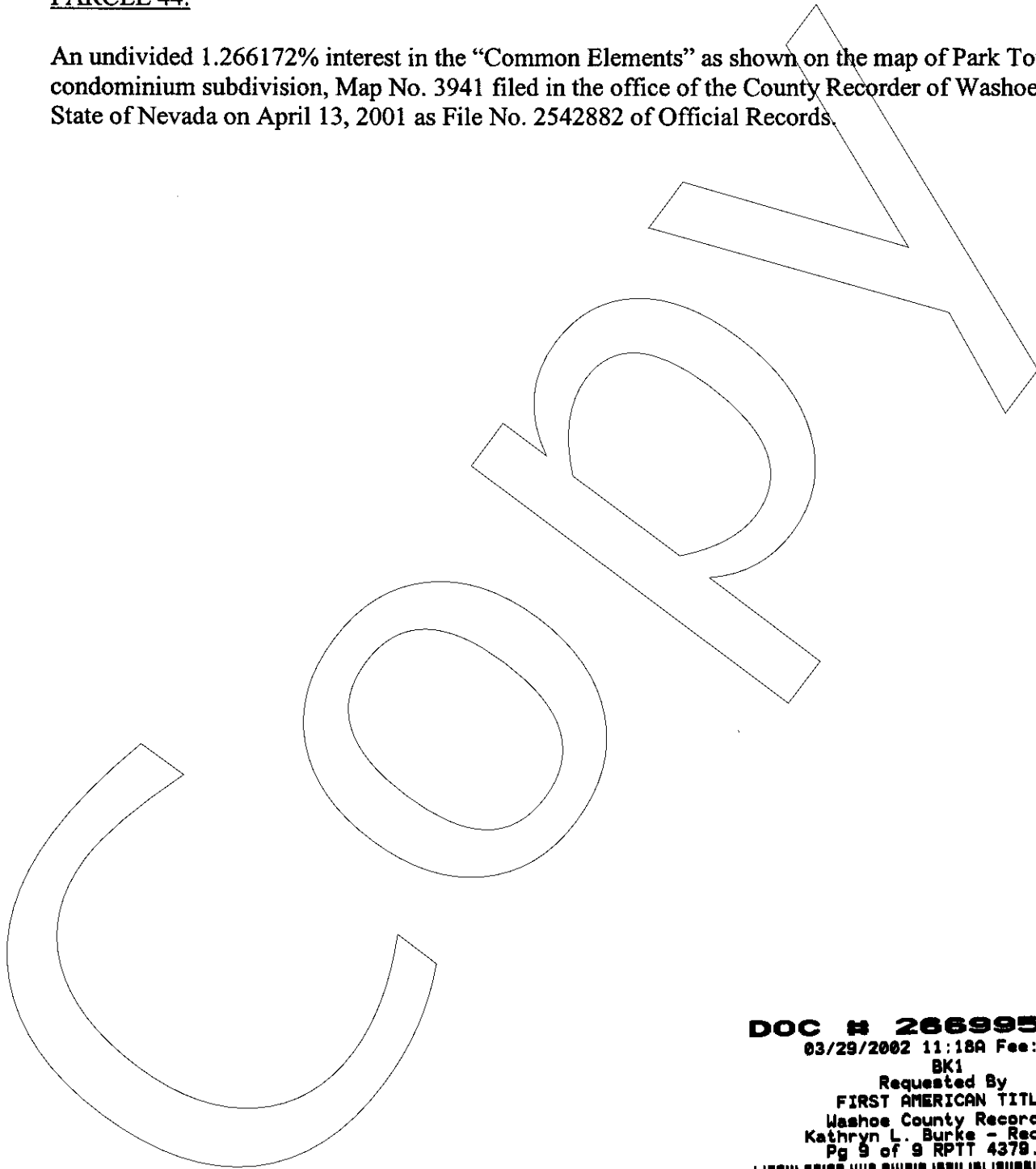

**DOC # 2669957**  
03/29/2002 11:18A Fee:22.00  
BK1  
Requested By  
FIRST AMERICAN TITLE  
Washoe County Recorder  
Kathryn L. Burke - Recorder  
Pg 9 of 9 RPTT 4379.25

